

HONEYWAGON



EMERALD GREEN
IS THE NEW GREEN

100% Solar & Battery Powered Trailers

SPECS

Trailer: 53' long
8'6" wide
13'5" high

Rooms: Front office 78 ft², All others 38 ft²

Stairs: 2'5" wide, extend 4' from trailer

Battery Capacity: 80 kWh

Solar Intake: 7.5 kW

Charger Type: 100A 4 pin

Fresh Water Tank Size: 420 gal.

Grey Water Tank Size: n/a

Black Water Tank Size: 420 gal.

FEATURES

- 8 offices
- 6 zone multi-split HVACs
- Multi-stall restrooms
- Wi-Fi

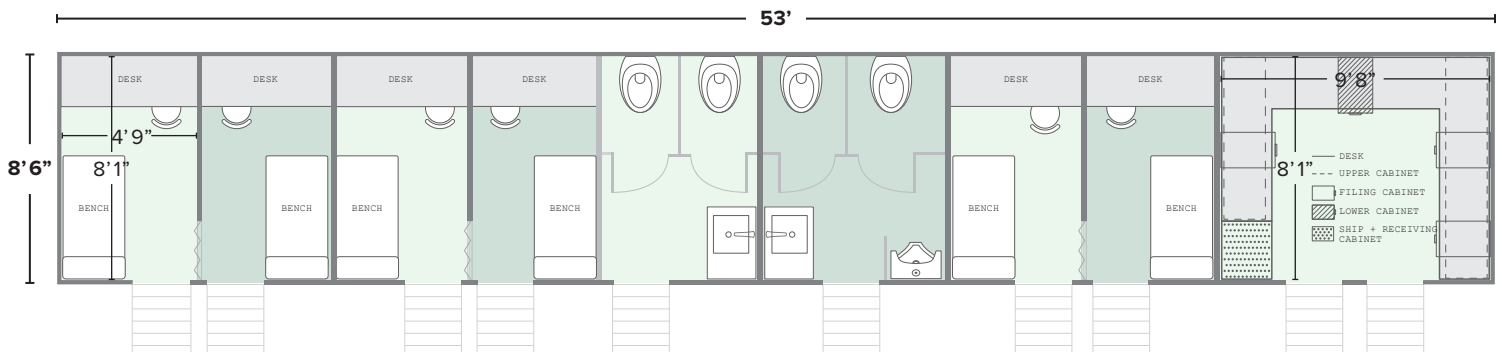

CONTACT

Keith Gordon, VP of Operations

M: (917) 968-3177 • O: (917) 922-4122

E: keith@emeraldtrailers.com

www.emeraldtrailers.com